



SPECIFICATIONS

MODEL	DC101	DC301	DC201
SYSTEM	2-WAY	2-WAY	2-WAY
IMPEDANCE	8 Ohm	8 Ohm	8 Ohm
MAXPOWER	60	70	50
R.M.S.	35	35	25
FREQUENCY RANGE	65-20k Hz	65-20k Hz	70-20k Hz
SENSITIVITY	88dB	87dB	84dB
FRAME DIMENSIONS	180 x 180mm	279 x 192mm	220x 146mm
CUTOUT DIMENSIONS	145x145mm	247x159mm	192x119mm
MOUNTING DEPTH	65mm	74mm	64mm
WEIGHT	1 kg	1.3 kg	0.8 kg

INSTALLATION

Prior to installation determine optimum positions for the speakers relevant to the listening position. Next ensure the location selected has sufficient depth in the wall or ceiling cavity (90mm or 3.25") from the face of the wall) and at least 40mm or 1.5" around the cutout for any framework and joinery so the clamps will function correctly. Synthetic fibrous material which is non moisture absorbing such as polyester fiber or fiberglass (handle with gloves and mask) may improve, sound by insulating resonance from an adjoining room, especially if the wall is an internal shared one.

STEP BY STEP

1. For optimum performance and convenience run 2 pairs of at least 16AWG good quality speaker cable to location of the speakers from the amplifier leaving an extra 600mm (24") protruding from the wall at the cutout. This will allow good working space at the back of the speakers on installation and easy removal if necessary.
2. Using the template included with the speaker mark the cut out lightly in pencil.
3. Using the jig saw or other suitable equipment carefully cut the hole for this speaker should measure hole size. To ensure the size is correct carefully install the speaker to verify the fit.
4. With a hooked piece of strong wire inserted at the corner of the speaker, gently pull to remove the grille and expose the mounting screws which will be tightened to operate the wall clamps.
5. Now that it all fits properly, strip 10mm or so of PVC from the cable and connect the twisted copper end to be inserted in the speakers play in phase. put the + wire to the red terminal at the amp and at the speaker.
6. As best as possible ensure the mounting screws allow the speaker to fit into the wall without too much play and then tighten the clamping screws through the front panel so the draw draw up on the other side of the wall. When the speaker is squarely mounted the screw can all be tightened.
7. Replace the grille and repeat for the other speaker being installed.

LOUDSPEAKER PLACEMENT

STEP 1

Using template provided, trace hole pattern on the wall.
Cut hole in the wall, following trace pattern.

STEP 2

Attach loudspeaker wires to speaker terminals
position speaker frame into cutout.

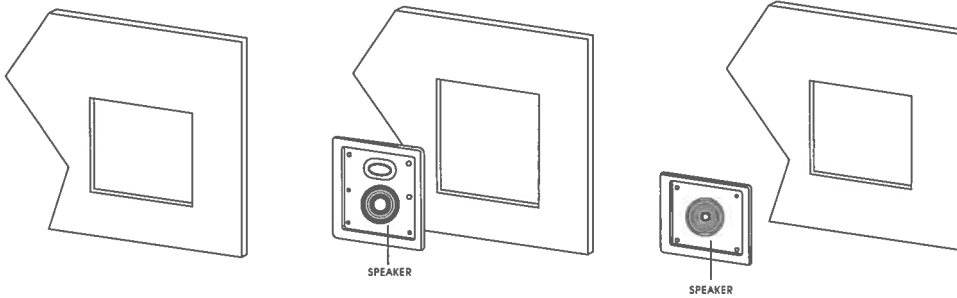

STEP 3

Carefully tighten the mounting screws. The mounting clamp will secure the speaker in place as the screws are tightened.

STEP 4

When satisfied the speaker is operational, insert the grille.

