



ir solutions

FROM DREAM TO REALITY

Just imagine: controlling a device from another room.
Or remaining in your seat while operating the amplifier wherever it is located,
and yes, this could be from behind your controller cabinet.
Who wouldn't dream of that? We use our wits applying our infrared
applications. Discover them here.

IR pro mount

expansion set

Operating out of sight AV equipment (in a cabinet or different room ...) via the trusted remote control? This professional infrared surface mounting kit ensures a discrete solution, allowing you to control 4 devices simultaneously. Expandable by addition of M1/M2 infrared transmitters.

- Six emitter output connections.
- IR confirmation LED.
- Status power input with LED indicator.
- Power input with LED indicator.
- 3,5mm input or interfacing with many brands of freestanding
- IR receivers.
- Detachable IR receiver connection.

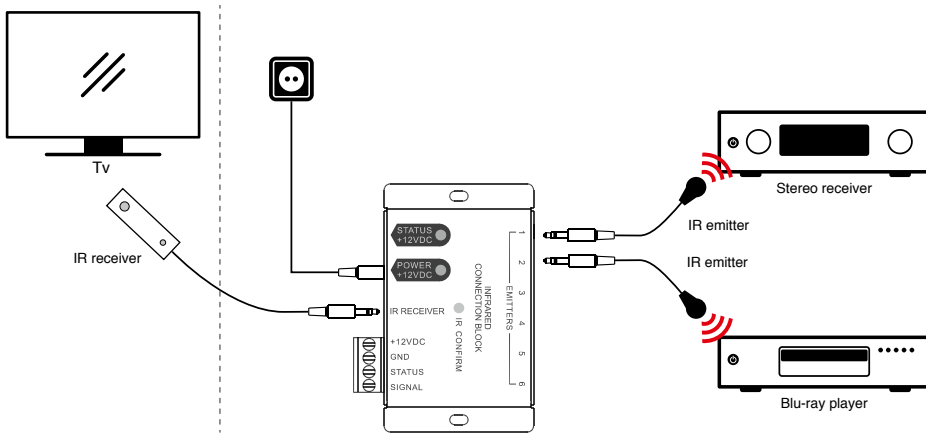

IR Receiver

receive frequency range	30 kHz to 60 kHz
transmit frequencies	38 kHz & 56 kHz
cord length	3m
connector type	3,5mm mini plug
power	12 V DC, 30mA max.
dimensions (h x w x d)	13 x 14 x 45mm
weight	28g

- A IR connecting block
- B IR receiver
- C dual IR emitters
- D power supply

IR connecting block

dimensions (h x w x d)	27 x 82 x 60mm
weight	110g

IR pro flush

expansion set

Operating out of sight AV equipment (in a cabinet or different room ...) via the trusted remote control? This professional IR installation kit ensures a discrete solution, allowing you to control 4 devices simultaneously. Expandable by addition of M1/M2 infrared transmitters.

- Six emitter output connections.
- IR confirmation LED.
- Status power input with LED indicator.
- Power input with LED indicator.
- 3,5mm input or interfacing with many brands of freestanding
- IR receivers.
- Detachable IR receiver connection.

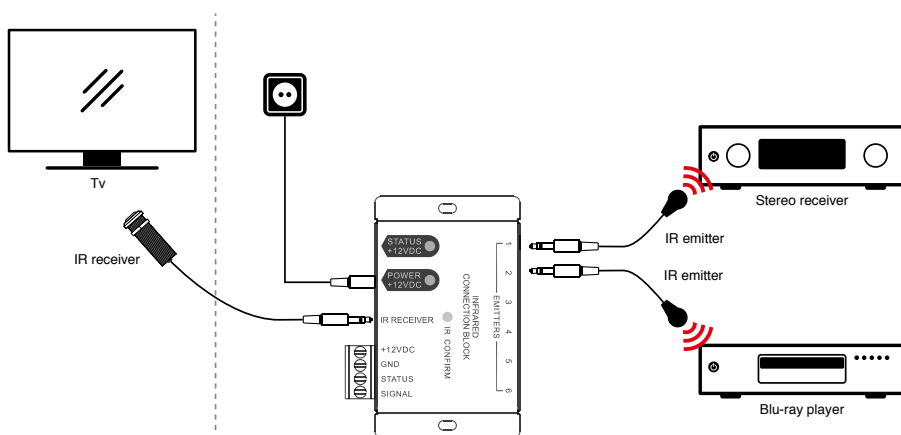

IR Receiver

receive frequency range	34 kHz to 60 kHz
transmit frequencies	38 kHz & 56 kHz
cord length	3m
connector type	3,5mm mini plug
power	12 V DC, 30mA max.
dimensions (l x Ø)	52.5 x 16.5mm
weight	54g

- A IR connecting block
- B IR receiver
- C dual IR emitters
- D power supply

IR connecting block

dimensions (h x w x d)	27 x 82 x 60mm
weight	110g

IR pro wireless

wireless transmission set

Infrared control, but completely wireless?

This professional IR/RF wireless solution allows full freedom of movement up to 200 metres.

Control 1 device from one TV or multiple devices from multiple TVs? Using the IR PRO WIRELESS it is a piece of cake.

- Connect the IR repeater wirelessly.
- Easy to control all home entertainment equipment in this system within a 200 metre radius (open space)
- No additional cables required



Setup 1

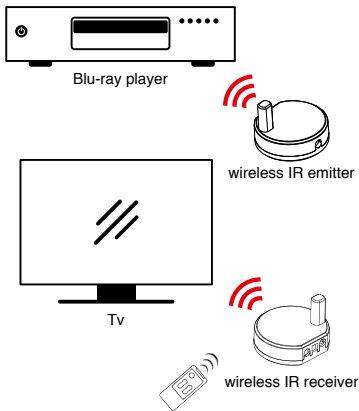

Setup 2

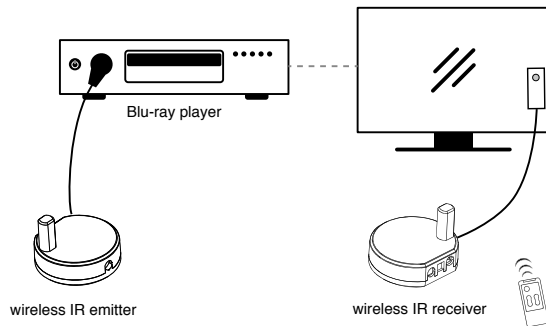

IR receiver / emitter

receive frequency range 20kHz to 60kHz

RF frequency 866Mhz

connector type 3,5mm mini plug

power 5V DC

dimensions (Ø x h) 45 x 32mm

weight 15g

- A IR receiver
- B IR emitter
- C IR emitter unit
- D IR receiver unit
- E power supply

IR usb wireless

wireless USB transmission set

Infrared control as well as ultimate user-convenience? This USB powered IR solution can easily be plugged into a vacant USB port of your TV. The IR signal will, as such, be forwarded completely wirelessly, at a range of 150 metres of open space, to a second USB dongle that is plugged in remotely. Using the smart channel selection, different combinations are possible within a single project.

- IR signal amplifier and IR extension feature
- RF working radius up to 100+ metres of open space
- High reception sensitivity (-90dBm)
- Bi-directional IR control across full band
- Channel selection

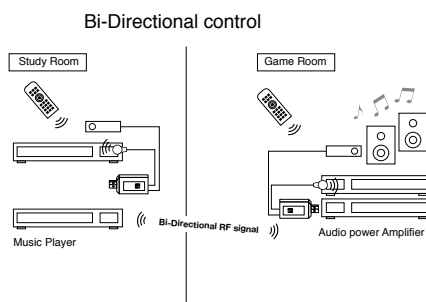
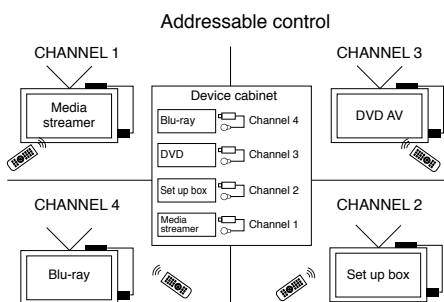
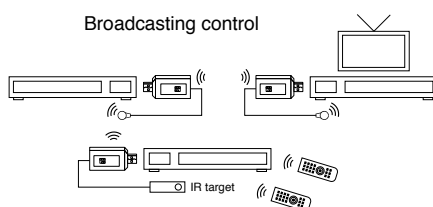
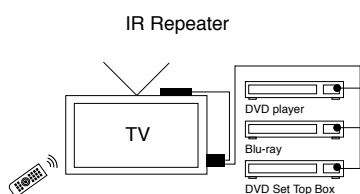
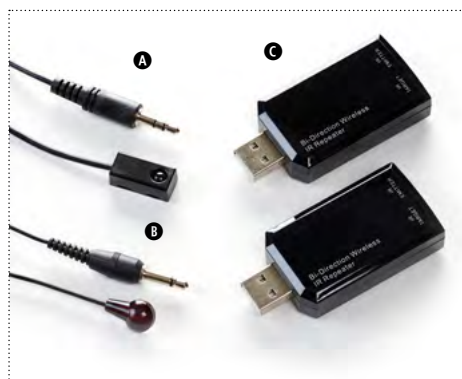

- A** IR receiver **B** IR emitter **C** wireless IR USB dongle

USB IR receiver / emitter

RF working range	150m
IR carrier tuning frequency	20~60kHz
dimensions (h x w x d)	27 x 82 x 60mm
weight	15g

IR receiver

receive frequency range	20kHz tot 60kHz
cord length	1,5m
connector type	3,5mm mini plug
dimensions (h x w x d)	7 x 9,4 x 20mm
weight	21g



IR extension cables

The single (M1) and double (M2) infrared extension cables are the perfect solution, in combination with other IR connection units, to remotely operate your out of sight AV equipment.

- IR frequency: 30-60 kHz
- Cable length: 3 m
- IR LEDs: [1 of 2]
- Range: 5 m

A M1 Single IR Flasher

Connect the mini-jack to the IR connection unit and attach the self-adhesive 'flasher' to the infrared window of, for instance, a CD player.

B M2 Double IR Flasher

Same as the single flasher, but suitable for connecting two image or sound systems.

